

vtech®

# Parent's Guide

*Myla's*  
**Sparkling**™  
*Friends* **+ Mia**



91-003822-000 (US) (CA)

# INTRODUCTION

Thank you for purchasing the **Myla's Sparkling Friends™ Mia!** Hi, I'm Mia, welcome to my colorful world of magic! Press my charm to choose a color, then touch my horn, eyes or wings to decorate them with that color. Let's have fun together!

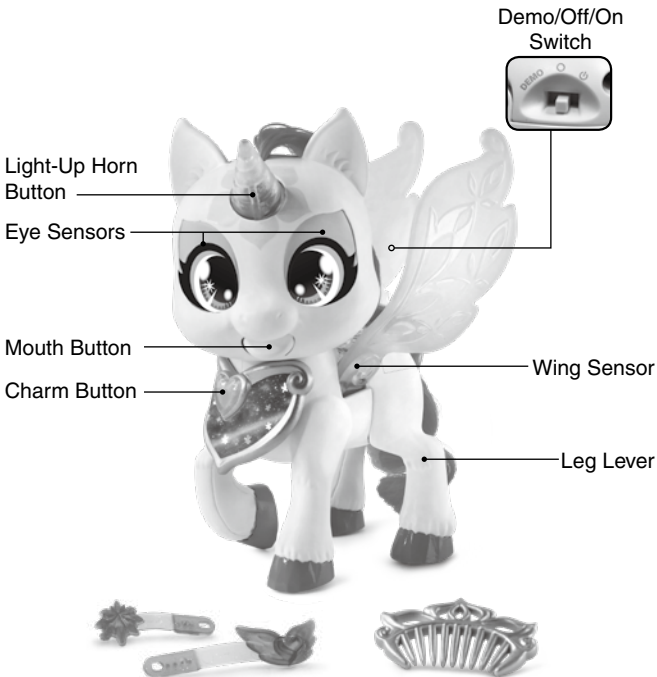

Hair Clips and Comb

# INCLUDED IN THIS PACKAGE

- Myla's Sparkling Friends™ Mia
- Two hair clips
- One comb
- Parent's guide

## WARNING:

All packing materials such as tape, plastic sheets, packaging locks, removable tags, cable ties, cords and packaging screws are not part of this toy and should be discarded for your child's safety.

## NOTE:

Please keep this parent's guide as it contains important information.

## ATTENTION :

Pour la sécurité de votre enfant, débarrassez-vous de tous les produits d'emballage tels que rubans adhésifs, feuilles de plastique, attaches, étiquettes et vis d'emballage. Ils ne font pas partie du jouet.

## NOTE :

Il est conseillé de conserver ce guide des parents car il comporte des informations importantes.

## Unlock the Packaging Locks

- ① Rotate the packaging lock counterclockwise several times.
- ② Pull out the packaging lock and discard.

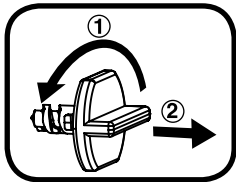

**NOTE:**

There are two cable ties at the bottom of the wings. These ties are packaging materials and should be discarded for your child's safety.

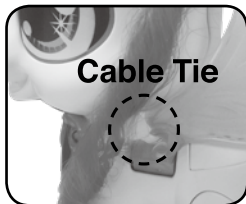

**WARNING:**

**CHOKING HAZARD** - small parts.  
Not for children under 3 years.



**ATTENTION :**

**DANGER D'ÉTOUFFEMENT** - Petits éléments.  
Ne convient pas aux enfants de moins de 3 ans.

# GETTING STARTED

The batteries included are for demo purposes only. Please replace the low capacity Try Me batteries with new batteries for the best performance. Slide the **Demo/Off/On Switch** to the **ON** position to start.

## NOTE:

Playing at close range for a prolonged period of time may cause fatigue or discomfort. We recommend that children take a 15-minute break for every hour of play.

## Battery Removal and Installation

1. Make sure the unit is turned **OFF**.
2. Locate the battery cover on the back of the unit, use a screwdriver to loosen the screw and open the battery box.
3. Remove old batteries by pulling up on one end of each battery.
4. Install 2 new AAA (AM-4/LR03) batteries following the diagram inside the battery box. (The use of new alkaline batteries is recommended for maximum performance).
5. Replace the battery cover and tighten the screw to secure.

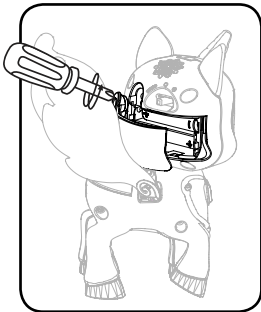

## **BATTERY NOTICE**

- Use new alkaline batteries for maximum performance.
- Use only batteries of the same or equivalent type as recommended.
- Do not mix different types of batteries: alkaline, standard (carbon-zinc) or rechargeable, or new and used batteries.
- Do not use damaged batteries.
- Insert batteries with the correct polarity(+ and -).
- Do not short-circuit the battery terminals.
- Remove exhausted batteries from the toy.
- Remove batteries during long periods of non-use.
- Do not dispose of batteries in fire.
- Do not charge non-rechargeable batteries.
- Remove rechargeable batteries from the toy before charging (if removable).
- Rechargeable batteries are only to be charged under adult supervision.

## **MISE EN GARDE**

- Utiliser des piles alcalines neuves pour des performances maximales
- Seules des piles du type recommandé doivent être utilisées.
- Ne pas mélanger différents types de piles ou d'accumulateurs, ne pas mélanger des piles ou des accumulateurs neufs avec des usagés.
- Ne pas utiliser des piles ou des accumulateurs endommagés.
- Mettre en place les piles ou les accumulateurs en respectant les polarités + et - .
- Ne pas mettre les bornes d'une pile ou d'un accumulateur en court-circuit (en reliant directement le + et le -) .
- Enlever les piles ou les accumulateurs usagés du jouet.
- Retirer les piles ou les accumulateurs en cas de nonutilisation prolongée.
- Ne les jeter ni au feu ni dans la nature.
- Ne pas tenter de recharger des piles non rechargeables.
- Enlever les accumulateurs du jouet pour les recharger.
- Les accumulateurs ne doivent être chargés que sous la surveillance d'un adulte.

# PRODUCT FEATURES

## 1. Demo/Off/On Switch

To turn the unit **ON**, slide the **Demo/Off/On Switch** to the **ON** position. To turn the unit **OFF**, slide the **Demo/Off/On Switch** to the **OFF** position.

## 2. Automatic Shut Off

To preserve battery life, Mia will automatically power down after several seconds without input. The unit can be turned on again by pressing the horn button, mouth button or charm button.

**NOTE:** If the unit powers down while playing, please install a new set of batteries.

# ACTIVITIES

## 1. Color Mia

Mia lights up in the colors you choose for her. Press Mia's **Charm Button** to choose a color. Then, touch her eyes, horn and wings to add the selected color to them.

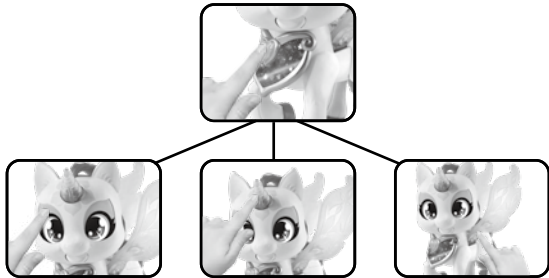

## 2. Mia's Mood

Mia expresses her mood through color. Press her **Light-Up Horn Button** to see how she feels. Then, touch her eyes or wings for some additional color commentary.



## 3. Color Fun

Mia likes to pick a lucky color for you. Press her **Wing Sensor** and she'll select a lucky color and tell you how that color makes her feel.



## 4. Tell Mia Your Wishes

Mia wants you to share your wishes and dreams with her. Cover and hold one of Mia's **Eye Sensors** and she'll ask you to tell her your wishes. Keep her **Eye Sensor** covered as you tell her. Uncover her **Eye Sensor** and she'll tell you how much she loves your wishes.



## 5. Musical Mia

Mia loves to sing. Tap Mia's **Mouth Button**, and she will sing, hum or even surprise you with a kiss! Careful, sometimes she even burps!



## 6. Flying Fun

Mia loves to fly! Help her flap her wings by pressing her **Leg Lever**. She'll make magical sounds and cheer as she pretends to zoom through the sky.





## 7. Cuddle and Care

Every unicorn needs love. Pet Mia's **Eye Sensors** or **Wing Sensor** to take care of her and get some fun surprises.



## CARE & MAINTENANCE

1. Keep the unit clean by wiping it with a slightly damp cloth.
2. Keep the unit out of direct sunlight and away from any direct heat sources.
3. Remove the batteries when the unit is not in use for an extended period of time.
4. Do not drop the unit on a hard surface and do not expose the unit to excess moisture.

## TROUBLESHOOTING

If for some reason the unit stops working or malfunctions, please follow these steps:

1. Turn the unit **Off**.
2. Interrupt the power supply by removing the batteries.
3. Let the unit stand for a few minutes, then replace the batteries.
4. Turn the unit **On**. The unit will now be ready to play again.
5. If the unit still does not work, install a new set of new batteries.

### **IMPORTANT NOTE:**

If the problem persists, please call our **Consumer Services Department** at **1-800-521-2010** in the U.S. **1-877-352-8697** in Canada, or visit our website **vtechkids.com** and fill out our Contact Us form located under the Customer Support link. Creating and developing VTech products is accompanied by a responsibility that we take very seriously. We make every effort to ensure the accuracy of the information, which forms the value of our products. However, errors sometimes can occur. It is important for you to know that we stand behind our products and encourage you to contact us with any problems and/or suggestions you might have. A service representative will be happy to help you.

### **CAUTION:**

Changes or modifications not expressly approved by the party responsible for compliance could void the user's authority to operate the equipment.

### **NOTE:**

This equipment has been tested and found to comply with the limits for a Class B digital device, pursuant to Part 15 of the FCC Rules. These limits are designed to provide reasonable protection against harmful interference in a residential installation. This equipment generates, uses and can radiate radio frequency energy and, if not installed and used in accordance with the instructions, may cause harmful interference to radio communications. However, there is no guarantee that interference will not occur in a particular installation. If this equipment does cause harmful interference to radio or television reception, which can be determined by turning the equipment off and on, the user is encouraged to try to correct the interference by one or more of the following measures:

- Reorient or relocate the receiving antenna.
- Increase the separation between the equipment and receiver.
- Connect the equipment into an outlet on a circuit different from that to which the receiver is connected.
- Consult the dealer or an experienced radio/TV technician for help.

## **Supplier's Declaration of Conformity**

Trade Name: VTech®  
Model: 5308  
Product Name: Myla's Sparkling Friends™ Mia  
Responsible Party: VTech Electronics North America, LLC  
Address: 1156 W. Shure Drive, Suite 200,  
Arlington Heights, IL 60004  
Website: vtechkids.com

THIS DEVICE COMPLIES WITH PART 15 OF THE FCC RULES. OPERATION IS SUBJECT TO THE FOLLOWING TWO CONDITIONS: (1) THIS DEVICE MAY NOT CAUSE HARMFUL INTERFERENCE, AND (2) THIS DEVICE MUST ACCEPT ANY INTERFERENCE RECEIVED, INCLUDING INTERFERENCE THAT MAY CAUSE UNDESIRE OPERATION.  
CAN ICES-3 (B)/NMB-3(B)

**CLASS 1  
LED PRODUCT**

**Visit our website for more  
information about our products,  
downloads, resources and more.**

***vtechkids.com***

Read our complete warranty policy online at  
*vtechkids.com/warranty*

